

Tucker's Walk

Concord, NC

Newly Constructed Medical Office Space



Harris Rd. & Poplar Tent Rd.

1,662 SF Available



BUILDING FEATURES

- Brand new construction in Tucker's Walk Medical Park.
- Impacted by the coming improvements to Route 73, improving access to I-85
- Excellent demographics in high-growth region of Concord, surrounded by new residential development as a traffic driver
- Offering full service leases and flexible terms on a variety of small to medium size options.



Mike Longmore
704.749.4880
mlongmore@kourycorp.com

336.299.9200
KouryCorp.com

KOURY
CORPORATION
BUILDER & DEVELOPER

Tucker's Walk

Concord, NC



Harris Road

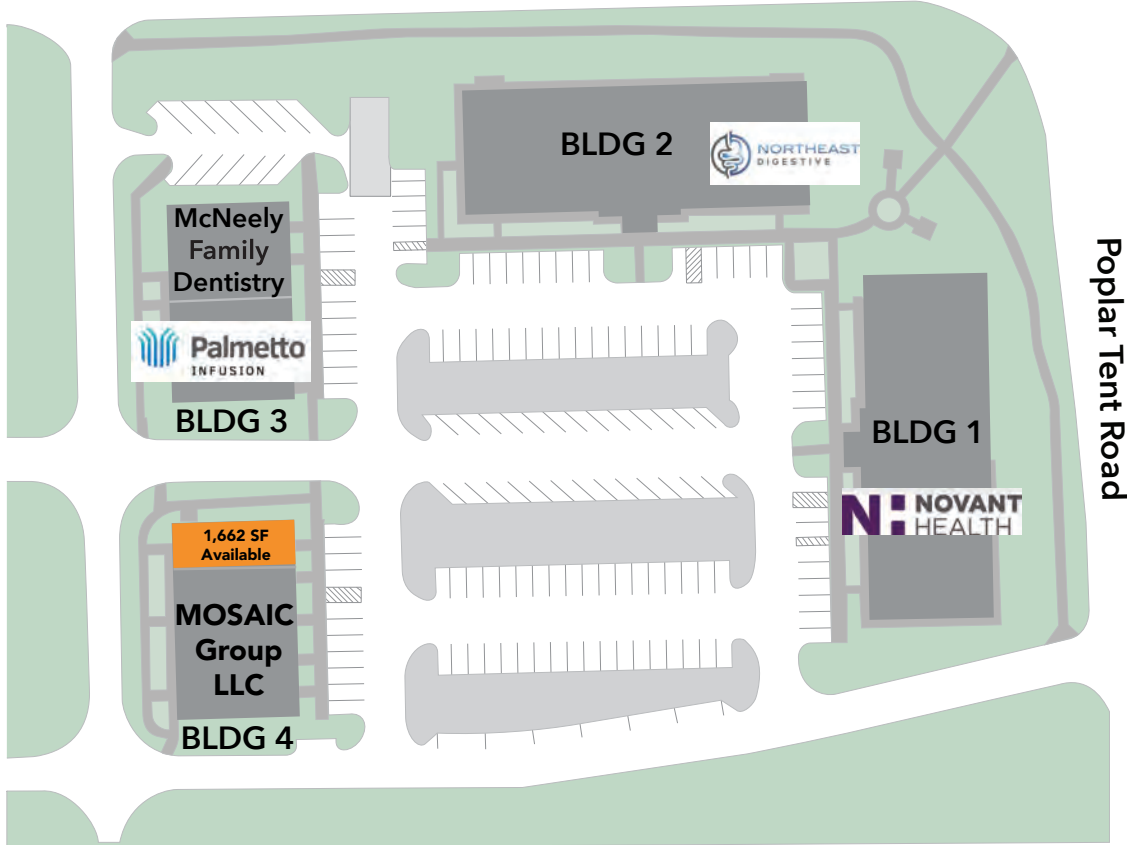

336.299.9200
KouryCorp.com



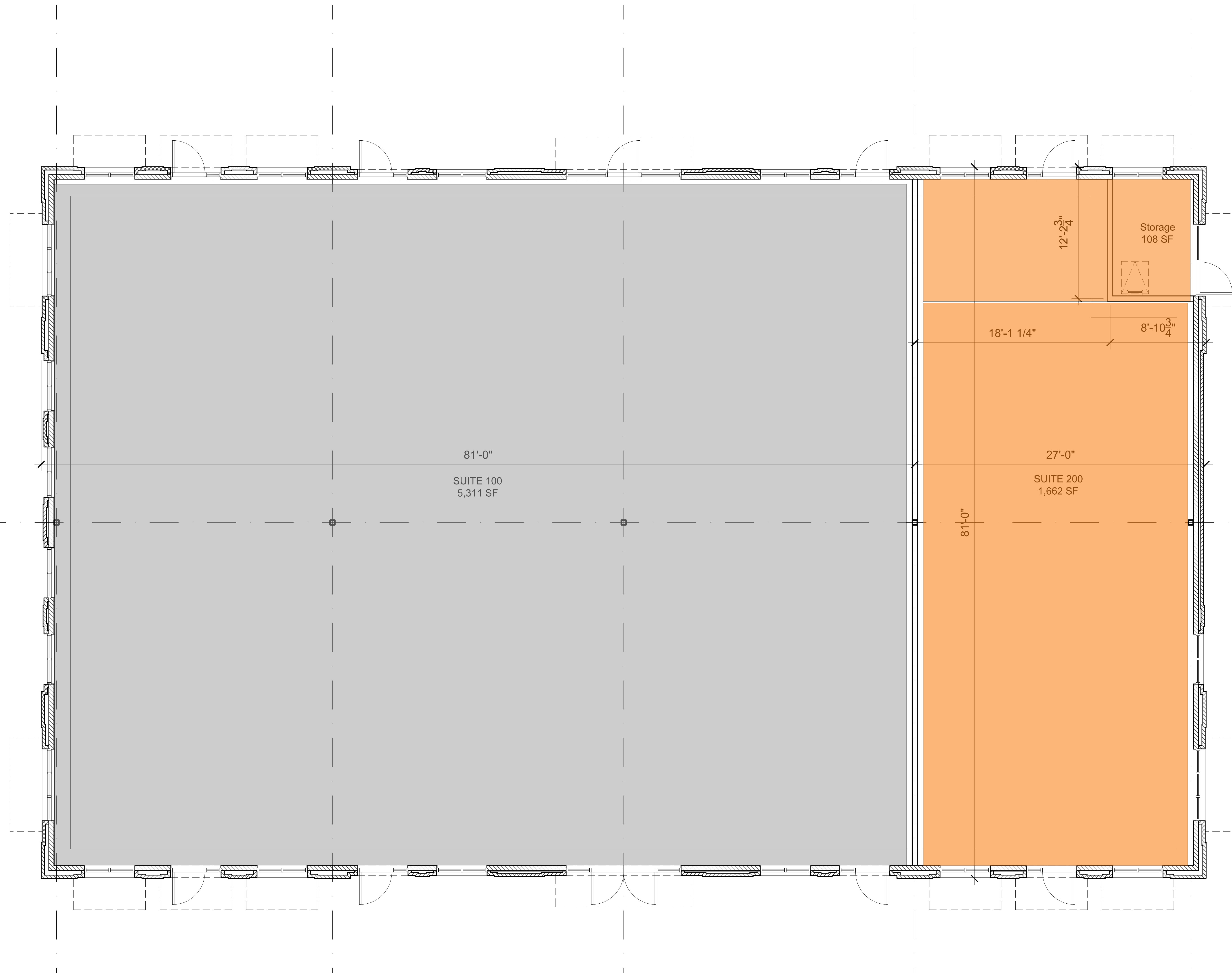

CANNON CROSSROADS - BUILDING 4

PROPOSED FLOOR PLAN - RJa Project #1867 - 04/08/22 - SCALE: 1/4" = 1'-0"

+/- 7,081 GROSS SF

THESE PLANS ARE PRELIMINARY USE ONLY AND SHALL NOT BE USED FOR FINAL PRICING, PERMITTING, CONSTRUCTION OR AS AN EXHIBIT IN ANY OFFICIAL AGREEMENTS. THESE PLANS ARE PROVIDED TO REFLECT THE ARCHITECTURAL STYLE AND QUALITY OF THE BUILDING TO BE CONSTRUCTED ON SITE. THE ACTUAL BUILDING CONSTRUCTED ON THE SITE MAY HAVE MINOR VARIATIONS FROM THIS ILLUSTRATION THAT ADHERE TO THE GENERAL ARCHITECTURAL CONCEPTS AND INTENT ILLUSTRATED



ROBERT JOHNSON
architects

1808 West Morehead St.
Charlotte, NC 28208
T 704 / 342.1058
E info@rjarchitects.com